



Leicester  
City Council

## **LICENSING (HEARINGS) SUB-COMMITTEE**

**DATE: THURSDAY, 27 JUNE 2019**

**TIME: 9:30 am**

**PLACE: Meeting Room G.03 - City Hall, 115 Charles Street,  
Leicester, LE1 1FZ**

### **Members of the Sub-Committee**

Councillors Cank, Sangster and Thomas.

Members of the Sub-Committee are summoned to attend the above meeting to consider the items of business listed overleaf.

for Monitoring Officer

**Officer contact:** Angie Smith / Aqil Sarang / Edmund Brown  
Democratic Support, Leicester City Council  
City Hall, 115 Charles Street, Leicester, LE1 1FZ  
Tel: 0116 454 6354 / 5591 / 3833

email: [angie.smith@leicester.gov.uk](mailto:angie.smith@leicester.gov.uk) / [aqil.sarang@leicester.gov.uk](mailto:aqil.sarang@leicester.gov.uk) / [Edmund.Brown@leicester.gov.uk](mailto:Edmund.Brown@leicester.gov.uk)

## Information for members of the public

### Attending meetings and access to information

You have the right to attend formal meetings such as full Council, committee meetings & Scrutiny Commissions and see copies of agendas and minutes. On occasion however, meetings may, for reasons set out in law, need to consider some items in private.

Dates of meetings and copies of public agendas and minutes are available on the Council's website at [www.cabinet.leicester.gov.uk](http://www.cabinet.leicester.gov.uk), from the Council's Customer Service Centre or by contacting us using the details below.

### Making meetings accessible to all

Wheelchair access – Public meeting rooms at the City Hall are accessible to wheelchair users. Wheelchair access to City Hall is from the middle entrance door on Charles Street - press the plate on the right hand side of the door to open the door automatically.

Braille/audio tape/translation - If you require this please contact the Democratic Support Officer (production times will depend upon equipment/facility availability).

Induction loops - There are induction loop facilities in City Hall meeting rooms. Please speak to the Democratic Support Officer using the details below.

Filming and Recording the Meeting - The Council is committed to transparency and supports efforts to record and share reports of proceedings of public meetings through a variety of means, including social media. In accordance with government regulations and the Council's policy, persons and press attending any meeting of the Council open to the public (except Licensing Sub Committees and where the public have been formally excluded) are allowed to record and/or report all or part of that meeting. Details of the Council's policy are available at [www.leicester.gov.uk](http://www.leicester.gov.uk) or from Democratic Support.

If you intend to film or make an audio recording of a meeting you are asked to notify the relevant Democratic Support Officer in advance of the meeting to ensure that participants can be notified in advance and consideration given to practicalities such as allocating appropriate space in the public gallery etc.

The aim of the Regulations and of the Council's policy is to encourage public interest and engagement so in recording or reporting on proceedings members of the public are asked:

- ✓ to respect the right of others to view and hear debates without interruption;
- ✓ to ensure that the sound on any device is fully muted and intrusive lighting avoided;
- ✓ where filming, to only focus on those people actively participating in the meeting;
- ✓ where filming, to (via the Chair of the meeting) ensure that those present are aware that they may be filmed and respect any requests to not be filmed.

### Further information

If you have any queries about any of the above or the business to be discussed, please contact Angie Smith, Democratic Support on **(0116) 454 6354** or email [angie.smith@leicester.gov.uk](mailto:angie.smith@leicester.gov.uk) / [agil.sarang@leicester.gov.uk](mailto:agil.sarang@leicester.gov.uk) / [Edmund.brown@leicester.gov.uk](mailto:Edmund.brown@leicester.gov.uk) or call in at City Hall, 115 Charles Street.

For Press Enquiries - please phone the **Communications Unit on 0116 454 4151**

## **PUBLIC SESSION**

### **AGENDA**

#### **FIRE/EMERGENCY EVACUATION**

If the emergency alarm sounds, you must evacuate the building immediately by the nearest available fire exit and proceed to area outside the Ramada Encore Hotel on Charles Street as Directed by Democratic Services staff. Further instructions will then be given.

**1. APPOINTMENT OF CHAIR**

**2. APOLOGIES FOR ABSENCE**

**3. DECLARATIONS OF INTEREST**

Members are asked to declare any interests they may have in the business to be discussed.

**4. MINUTES OF PREVIOUS MEETING**

**Appendix A**

The minutes of the meeting held on the 24 April 2019 are attached and members will be asked to confirm them as a correct record.

**5. APPLICATION FOR A VARIATION OF AN EXISTING PREMISES LICENCE: REVOLUTION, 6B NEW WALK, LEICESTER, LE1 6TF**

**Appendix B**

The Director of Neighbourhood and Environmental Services submits a report on an application for a variation for an existing premises licence for: Revolution, 6B New Walk, Leicester, LE1 6TF.

Report attached. A copy of the associated documentation is attached for Members only. Further copies are available on the Council's website at [www.cabinet.leicester.gov.uk](http://www.cabinet.leicester.gov.uk) or by phone Democratic Support on 0116 454 6358

(Wards affected: Castle)

**6. ANY OTHER URGENT BUSINESS**





Leicester  
City Council

Minutes of the Meeting of the  
LICENSING (HEARINGS) SUB-COMMITTEE

Held: WEDNESDAY, 24 APRIL 2019 at 9:30 am

P R E S E N T:

Councillor Thomas (Chair)

Councillor Hunter

Councillor Unsworth

\* \* \* \* \*

**96. APPOINTMENT OF CHAIR**

Councillor Thomas was elected as chair for the meeting.

**97. APOLOGIES FOR ABSENCE**

There were no apologies for absence.

**98. DECLARATIONS OF INTEREST**

There were no declarations of interest.

**99. MINUTES OF PREVIOUS MEETING**

The minutes of the previous meeting held on 29 March 2019 were confirmed as a correct record.

**100. APPLICATION FOR A NEW PREMISES LICENCE, CHIKANOS, 137  
GRANBY STREET, LEICESTER, LE1 6FJ**

The Director of Neighbourhood and Environmental Services submitted a report that required the Sub-Committee to determine an application for a new premises licence within the Cumulative Impact Zone for Chikanos, 137 Granby Street, Leicester, LE1 6FJ

The Sub-Committee noted that a representation had been received which necessitated that the application for a new premises had to be considered by the Sub-Committee.

The applicant was present, two local residents and the Ward Councillor for Castle Ward were present at the meeting. The Chief Licensing Officer and The Legal Advisor to the Sub-Committee were also present.

Introductions were made and the procedure for the meeting was outlined to those present.

The Chief Licensing Officer presented the report and outlined details of the application. It was noted that a representation had been received from a local resident and from a Ward Councillor on behalf of another resident relating to the licensing objective the prevention of public nuisance and public safety.

The local residents and the Ward Councillor then outlined the reasons for the representations and answered questions from the Sub-Committee.

The applicant was then given the opportunity to respond to the points made and answered questions from the sub-Committee.

All parties were then given the opportunity to sum up their positions and make any final comments.

Prior to the Sub-Committee considering the application, the Legal Advisor to the Sub-Committee advised on the options available to them in making a decision, and relevant policy and statutory guidance that needed to be taken into account when making their decision.

In reaching their decision the Sub-Committee felt they should deliberate in private on the basis that this was in the public interest and as such outweighed the public interest of their deliberation taking place with the parties represented being present.

The Licensing Team Manager, Legal Advisor to the Sub-Committee, the applicant, both local residents and the Ward Councillor then withdrew from the meeting.

The Sub-Committee then gave the application full and detailed consideration.

**RESOLVED:**

That the application for a new premises licence, Chickanos, 137 Granby Street, Leicester, LE1 6FJ be GRANTED.

**REASON FOR THE DECISION:**

In reaching their decision the Sub-Committee had carefully considered the committee report, the presentation by the legal officer, all representations submitted by Chadwick Foods Ltd, the representations from the local residents and the legal advice given during the hearing.

The Sub-Committee were asked to determine an application for a new premises licence at Chickanos, 137 Granby Street, Leicester.

When Considering this matter, the licensing objectives were of paramount concern. The Sub-Committee had considered the application on its own merits.

The application had been made by Chadwick Foods Ltd in accordance with Section 17 of the Licensing Act 2003.

Chadwick Foods Ltd, wished to provide late night refreshment from the premises between the hours from 11am and 11pm Sunday to Thursday and 11pm to 2am Friday and Saturday. Representations had been received from a local resident and a Ward Councillor on behalf of another local resident who stated they were concerned that the grant of the licence would add to the ongoing noise nuisance from the premises and surrounding area and the ongoing anti-social behaviour.

The Sub-Committee had considered each of the options available to the Licensing Committee.

As a result of what the Sub-Committee had heard, the Sub-Committee were content to grant the application on the basis that the hours applied for by the applicant were reasonable due to the position of the business and the surrounding area.

The Sub-Committee did however feel that the following conditions should be added to the licence to alleviate the concerns of the residents:

1. Deliveries to the premises will not take place outside of the hours of 7am and 5pm
2. Staff at the premises to be placed on a rota regarding when breaks should be taken to prevent large groups from gathering together outside of the premises.
3. A designated area for staff to take their breaks by the wall area to reduce the noise experienced by the residents.
4. The Noise Team from Leicester City Council to visit the premises to assess the extractor fan to ensure it is fitted correctly and alleviates any excessive noise.

All parties were reminded that they had 21 days to appeal this decision.

#### **101. ANY OTHER URGENT BUSINESS**

There being no items of urgent business the meeting was declared closed at 10:50am.







Leicester  
City Council

**WARDS AFFECTED**  
**Castle**

**FORWARD TIMETABLE OF CONSULTATION AND MEETINGS:**  
**Hearing under the Licensing Act 2003**

**27 June 2019**

---

**Application for a variation of an existing premises licence**  
**Revolution 6b New Walk, Leicester LE1 6TF**

---

**Report of the Director of Neighbourhood and Environmental Services**

**1. Purpose of Report**

- 1.1. This report provides information for Members about an application made under the Licensing Act 2003, to assist them in determining the outcome of that application.

**2. Determination to be made**

- 2.1. Having considered the application and representations, Members must consider whether to
- Grant the licence without modification
  - Modify the conditions of the licence
  - Reject the whole application

**3. Summary**

- 3.1 This report outlines an application for a variation to an existing premises licence for Revolution and summarises the representations received. It also highlights the licensing objectives, the relevant parts of the guidance and regulations, and the pertinent sections of the Licensing Authority's Licensing Policy.

## 4 Location Plan

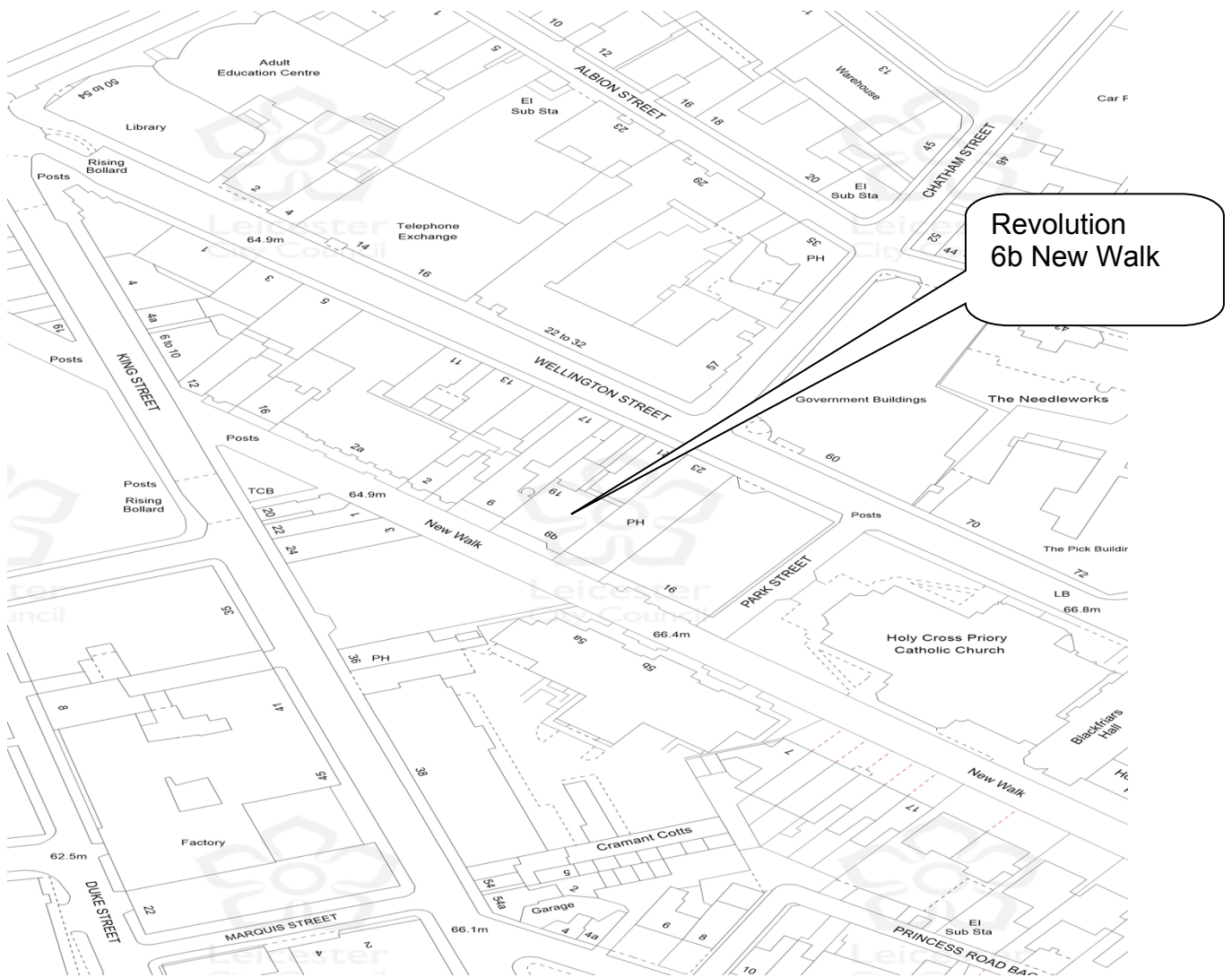

## 5 Existing Licence

5.1 The existing licence is attached at Appendix A.

## 6 Application

6.1 An application was received on 15 May 2019 from Revolution Bars Limited for a variation to an existing premises licence for Revolution 6b New Walk. A copy of the application is attached at Appendix B.

6.2 The variation sought by the application is as follows:

Licensable activity	Current Hours	Proposed Hours
Late night refreshment	None	23.00 - 03.00 Mon-Sun

## 7 Steps to Promote the Licensing Objectives

- 7.1 The steps the applicant proposes to take to promote the licensing objectives are set out in the operating schedule (see section M of Appendix B).
- 7.2 In arriving at its decision on the application, the Licensing Authority's primary consideration must be the promotion of the licensing objectives.

## 8 Representation

- 8.1 Representations were received on 5 June 2019 from local residents. The representations relate to the prevention of crime and disorder and the prevention of public nuisance. The local residents are concerned that there will be an increase in noise levels in a residential area that is already often at a barely tolerable level. The proposed delivery service is certain to exacerbate the nuisance this causes to residents. The residents are concerned that delivery companies are using New Walk as a quick conduit for deliveries. A copy of the representations are attached at Appendix C and Appendix C.1.

## 9 Conditions

- 10.1 The conditions that are consistent with the operating schedule and the representation are attached at Appendix D.

## 10. Statutory Guidance

- 11.1 Any decision made by the Licensing Authority must be in accordance with the licensing objectives. In addition, the government has issued guidance under section 182 of the Licensing Act 2003. The parts of the guidance that are particularly relevant in this case are as follows:

Section	Heading
1.2 – 1.5	Licensing objectives and aims
1.15 – 1.16	General Principles
1.17	Each application on its own merits
2.1 – 2.6	Crime & Disorder
2.7 – 2.14	Public Safety
2.15 – 2.21	Public nuisance
2.22 – 2.31	Protection of children from harm
3.12 – 3.20	Late night refreshment
8.41 – 8.49	Steps to promote the licensing objectives
9.11 – 9.12	Role of responsible authorities
9.13 – 9.19	Licensing Authorities acting as responsible authorities
9.20 – 9.24	Health bodies acting as responsible authorities
9.25	Home Office (Immigration Enforcement) acting as a responsible authority
9.31 – 9.41	Hearings
9.42 – 9.44	Determining actions that are appropriate for the promotion of the licensing objectives
10.1 – 10.3	Conditions - general

10.8 – 10.9	Imposed conditions
10.10	Proportionality
10.13 - 10.15	Hours of trading
10.25 – 10.66	Mandatory conditions in relation to the supply of alcohol
13.10 – 13.11	Giving reasons for decisions
14.51 – 14.52	Licensing Hours
16.1 – 16.69	Regulated entertainment

## 12 Statement of Licensing Policy

12.1 The relevant parts of the Licensing Authority's Statement of Licensing Policy are as follows:

Section	Heading
2	Fundamental Principles
5	Licensing Hours
7	Prevention of Crime and Disorder
9	Prevention of Public Nuisance
12	Duplication
13	Standardised conditions

## 13. Points for Clarification

13.1 The applicant and the party / parties making the representation have been asked to clarify certain points at the hearing, as follows:

### *By the applicant*

1. Whether the applicant considers that the concerns outlined in the representations are valid, and if not why not?
2. In the light of the representations made, does the applicant wish to propose any additional steps for the promotion of the licensing objectives?

### *By the party making the representation*

1. Whether they have any additional information to support the representation they have made?
2. Whether there are any additional steps that could be taken which would be equally effective in the promotion of the licensing objectives?

## 14. Other Implications

OTHER IMPLICATIONS	YES/ NO	Paragraph/References Within Supporting information
Equal Opportunities	No	
Policy	No	
Sustainable and Environmental	No	
Crime and Disorder	Yes	

Human Rights Act	No	
Elderly/People on Low Income	No	
Corporate Parenting	No	
Health Inequalities Impact	No	

**15. Background Papers – Local Government Act 1972**

- a. None

**16. Consultations**

- a. As this application was received electronically, the Licensing Authority was required to consult with the relevant responsible authorities as set out in the Licensing Act 2003.

**17. Report Author**

Jean Arnold  
Licensing Officer  
Telephone number 0116 454 3049  
jean.arnold@leicester.gov.uk

<b>APPENDIX</b>	<b>CONTENT</b>
A	Existing licence
B	Application
C	Representations
D	Conditions consistent with application and representation / agreement



Licensing Act 2003

**Premises Licence****LEIPRM0552**

Leicester  
City Council

Local Services & Enforcement  
Leicester City Council  
York House  
91 Granby Street  
Leicester  
LE1 6FB

(0116) 4543040  
[licensing@leicester.gov.uk](mailto:licensing@leicester.gov.uk)

## Part 1 - Premises Details

## POSTAL ADDRESS OF PREMISES, OR IF NONE, ORDNANCE SURVEY MAP REFERENCE OR DESCRIPTION

**Revolution**

6b New Walk / 19 Wellington Street, Leicester, LE1 6TF.

## WHERE THE LICENCE IS TIME LIMITED THE DATES

Not applicable

Expires **no expiry**

## LICENSABLE ACTIVITIES AUTHORISED BY THE LICENCE

- a performance of live music
- any playing of recorded music
- the supply of alcohol

## THE TIMES THE LICENCE AUTHORISES THE CARRYING OUT OF LICENSABLE ACTIVITIES

Activity (and Area if applicable)	Description	Time From	Time To
E. Performance of live music (Indoors)	Mon-Sun	11:00am	3:00am
F. Playing of recorded music (Indoors)	Mon-Sun	11:00am	3:00am
J. Supply of alcohol for consumption ON and OFF the premises	Mon-Sun	11:00am	3:00am

## THE OPENING HOURS OF THE PREMISES

Description	Time From	Time To
Mon-Sun	9:00am	3:30am

## WHERE THE LICENCE AUTHORISES SUPPLIES OF ALCOHOL WHETHER THESE ARE ON AND / OR OFF SUPPLIES

- J. Supply of alcohol for consumption ON and OFF the premises

## Part 2

## NAME, (REGISTERED) ADDRESS, TELEPHONE NUMBER AND EMAIL (WHERE RELEVANT) OF HOLDER OF PREMISES LICENCE

Revolution Bars Ltd

21 Old Street, Ashton under Lyne, OL6 6LA.



Licensing Act 2003

# Premises Licence

# LEIPRM0552



Leicester  
City Council

Local Services & Enforcement  
Leicester City Council  
York House  
91 Granby Street  
Leicester  
LE1 6FB

(0116) 4543040  
[licensing@leicester.gov.uk](mailto:licensing@leicester.gov.uk)

REGISTERED NUMBER OF HOLDER, FOR EXAMPLE COMPANY NUMBER, CHARITY NUMBER (WHERE APPLICABLE)

NAME, ADDRESS AND TELEPHONE NUMBER OF DESIGNATED PREMISES SUPERVISOR WHERE THE PREMISES LICENCE AUTHORISES THE SUPPLY OF ALCOHOL

Ashley James WILLIAMS

PERSONAL LICENCE NUMBER AND ISSUING AUTHORITY OF PERSONAL LICENCE HELD BY DESIGNATED PREMISES SUPERVISOR WHERE THE PREMISES LICENCE AUTHORISES FOR THE SUPPLY OF ALCOHOL

Licence No. LEIPRS3948

Issued by Leicester





Licensing Act 2003

**Premises Licence****LEIPRM0552**

Leicester  
City Council

Local Services & Enforcement  
Leicester City Council  
York House  
91 Granby Street  
Leicester  
LE1 6FB

(0116) 4543040  
[licensing@leicester.gov.uk](mailto:licensing@leicester.gov.uk)

**ANNEXES****Annex 1 - Mandatory conditions**

No supply of alcohol may be made under the premises licence -

- a) at a time when there is no designated premises supervisor in respect of the premises licence, or
- b) at a time when the designated premises supervisor does not hold a personal licence or his personal licence is suspended.

Every supply of alcohol under the premises licence must be made or authorised by a person who holds a personal licence.

The responsible person must ensure that staff on relevant premises do not carry out, arrange or participate in any irresponsible promotions in relation to the premises. In this paragraph, an irresponsible promotion means any one or more of the following activities, or substantially similar activities, carried on for the purpose of encouraging the sale or supply of alcohol for consumption on the premises-

- a) games or other activities which require or encourage, or are designed to require or encourage, individuals to-
  - i) drink a quantity of alcohol within a time limit (other than to drink alcohol sold or supplied on the premises before the cessation of the period in which the responsible person is authorised to sell or supplied alcohol), or
  - ii) drink as much alcohol as possible (whether within a time limit or otherwise);
- b) provision of unlimited or unspecified quantities of alcohol free or for a fixed or discounted fee to the public or to a group defined by a particular characteristic in a manner which carries a significant risk of undermining a licensing objective;
- c) provision of free or discounted alcohol or any other thing as a prize to encourage or reward the purchase and consumption of alcohol over a period of 24 hours or less in a manner which carries a significant risk of undermining a licensing objective;
- d) selling or supplying alcohol in association with promotional posters or flyers on, or in the vicinity of, the premises which can reasonably be considered to condone, encourage or glamorise anti-social behaviour or to refer to the effects of drunkenness in any favourable manner;
- e) dispensing alcohol directly by one person into the mouth of another (other than where that other person is unable to drink without assistance by reason of a disability).

The responsible person must ensure that free potable water is provided on request to customers where it is reasonably available.

The premises licence holder or club premises certificate holder must ensure that an age verification policy is adopted in respect of the premises in relation to the sale or supply of alcohol.

The designated premises supervisor in relation to the premises licence must ensure that the supply of alcohol at the premises is carried on in accordance with the age verification policy.

The policy must require individuals who appear to the responsible person to be under 18 years of age (or such older age as may be specified in the policy) to produce on request, before being served alcohol, identification bearing their photograph, date of birth and either-

- a) a holographic mark, or
- b) an ultraviolet feature.

The responsible person shall ensure that-

- a) where any of the following alcoholic drinks is sold or supplied for consumption on the premises (other than alcoholic drinks sold or supplied having been made up in advance ready for sale or supply in a securely closed container) it is available to customers in the following measures-
  - i) beer or cider: ½ pint;
  - ii) gin, rum, vodka or whisky: 25 ml or 35 ml; and
  - iii) still wine in a glass: 125 ml;
- b) these measures are displayed in a menu, price list or other printed material which is available to customers on the premises; and
- c) where a customer does not in relation to a sale of alcohol specify the quantity of alcohol to be sold, the customer is made aware that these measures are available.

A relevant person shall ensure that no alcohol is sold or supplied for consumption on or off the premises for a price which is less than the permitted price.

**Annex 2 - Conditions consistent with the operating schedule**

Licensable activities may continue between the end of the hours permitted by the licence on New Years Eve and the start of the hours permitted by the licence on New Years Day.



Licensing Act 2003

# Premises Licence

# LEIPRM0552



Leicester  
City Council

Local Services & Enforcement  
Leicester City Council  
York House  
91 Granby Street  
Leicester  
LE1 6FB

(0116) 4543040  
[licensing@leicester.gov.uk](mailto:licensing@leicester.gov.uk)

## ANNEXES continued ...

The premises are structurally adapted and bona fide/intended to be used for the purpose of providing for persons resorting to the premises music and dancing and substantial refreshment to which the sale of intoxicating liquor is ancillary.

On the morning when summer time begins, alcohol may be sold and regulated entertainment may be provided until 3am.

Consumption of liquor and other refreshments in the outside area on the plan shall be restricted to those persons seated at tables serviced by waiter/waitresses to a terminal hour of 11.00pm. This facility to be closed under the direction of a police officer either during or in anticipation of public disorder.

CCTV to be installed, operated and maintained both internally and externally under the direction of the Crime Prevention Officer.

Windows and doors (apart from access and egress) to be kept closed during the provision of any regulated entertainment.

There shall be no external playing of amplified music and voice.

**Annex 3 - Conditions attached after a hearing by the Licensing Authority**

None.







Licensing Act 2003

# Premises Licence Summary

# LEIPRM0552



Leicester  
City Council

Local Services & Enforcement  
Leicester City Council  
York House  
91 Granby Street  
Leicester  
LE1 6FB

(0116) 4543040  
[licensing@leicester.gov.uk](mailto:licensing@leicester.gov.uk)

## Premises Details

POSTAL ADDRESS OF PREMISES, OR IF NONE, ORDNANCE SURVEY MAP REFERENCE OR DESCRIPTION

### Revolution

6b New Walk / 19 Wellington Street, Leicester, LE1 6TF.

WHERE THE LICENCE IS TIME LIMITED THE DATES

Not applicable

LICENSABLE ACTIVITIES AUTHORISED BY THE LICENCE

- a performance of live music
- any playing of recorded music
- the supply of alcohol

THE TIMES THE LICENCE AUTHORISES THE CARRYING OUT OF LICENSABLE ACTIVITIES

Activity (and Area if applicable)	Description	Time From	Time To
E. Performance of live music (Indoors)	Mon-Sun	11:00am	3:00am
F. Playing of recorded music (Indoors)	Mon-Sun	11:00am	3:00am
J. Supply of alcohol for consumption ON and OFF the premises	Mon-Sun	11:00am	3:00am

THE OPENING HOURS OF THE PREMISES

Description	Time From	Time To
Mon-Sun	9:00am	3:30am

WHERE THE LICENCE AUTHORISES SUPPLIES OF ALCOHOL WHETHER THESE ARE ON AND / OR OFF SUPPLIES

- J. Supply of alcohol for consumption ON and OFF the premises

NAME, (REGISTERED) ADDRESS OF HOLDER OF PREMISES LICENCE

Revolution Bars Ltd

21 Old Street, Ashton under Lyne, OL6 6LA.

REGISTERED NUMBER OF HOLDER, FOR EXAMPLE COMPANY NUMBER, CHARITY NUMBER (WHERE APPLICABLE)



Licensing Act 2003

# Premises Licence Summary

# LEIPRM0552

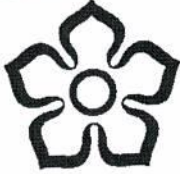

Leicester  
City Council

Local Services & Enforcement  
Leicester City Council  
York House  
91 Granby Street  
Leicester  
LE1 6FB

(0116) 4543040  
[licensing@leicester.gov.uk](mailto:licensing@leicester.gov.uk)

NAME OF DESIGNATED PREMISES SUPERVISOR WHERE THE PREMISES LICENCE AUTHORISES THE SUPPLY OF ALCOHOL

Ashley James WILLIAMS

STATE WHETHER ACCESS TO THE PREMISES BY CHILDREN IS RESTRICTED OR PROHIBITED

Restricted



## Application to vary a premises licence under the Licensing Act 2003

### PLEASE READ THE FOLLOWING INSTRUCTIONS FIRST

Before completing this form please read the guidance notes at the end of the form. If you are completing this form by hand please write legibly in block capitals. In all cases ensure that your answers are inside the boxes and written in black ink. Use additional sheets if necessary.

You may wish to keep a copy of the completed form for your records.

**I/We** Revolution Bars Limited

*(Insert name(s) of applicant)*

**being the premises licence holder, apply to vary a premises licence under section 34 of the Licensing Act 2003 for the premises described in Part 1 below**

<b>Premises licence number</b>
--------------------------------

LEIPRM0552
------------

#### Part 1 – Premises Details

Postal address of premises or, if none, ordnance survey map reference or description
--

Revolution 6b New Walk / 19 Wellington Street
--

Post town	Leicester	Postcode	LE1 6TF
-----------	-----------	----------	---------

Telephone number at premises (if any)	
---------------------------------------	--

Non-domestic rateable value of premises	£44,500.00
---	------------

#### Part 2 – Applicant details

Daytime contact telephone number	[REDACTED]
----------------------------------	------------

E-mail address (optional)	[REDACTED]
---------------------------	------------

Current postal address if different from premises address	21 Old Street
---	---------------

Post town	Ashton under Lyne	Postcode	OL6 6LA
-----------	-------------------	----------	---------

#### Part 3 - Variation

Please tick as appropriate

Do you want the proposed variation to have effect as soon as possible?

Yes

No

If not, from what date do you want the variation to take effect?

DD	MM	YYYY

Do you want the proposed variation to have effect in relation to the introduction of the late night levy? (Please see guidance note 1)  Yes  No

**Please describe briefly the nature of the proposed variation** (Please see guidance note 2)

The purpose of the application is to add the provision for late night refreshment to the licence so that it can be provided between 11pm and 3am daily (to coincide with the terminal hour for the sale of alcohol.)

This will allow the premises to provide hot food and drink at the premises after 11pm, and also as part of a delivery service, such as Deliveroo.

There are to be no other changes to the licence.

If your proposed variation would mean that 5,000 or more people are expected to attend the premises at any one time, please state the number expected to attend:



#### Part 4 Operating Schedule

Please complete those parts of the Operating Schedule below which would be subject to change if this application to vary is successful.

**Provision of regulated entertainment (Please see guidance note 3) Please tick all that apply**

- a) plays (if ticking yes, fill in box A)
- b) films (if ticking yes, fill in box B)
- c) indoor sporting events (if ticking yes, fill in box C)
- d) boxing or wrestling entertainment (if ticking yes, fill in box D)
- e) live music (if ticking yes, fill in box E)
- f) recorded music (if ticking yes, fill in box F)
- g) performances of dance (if ticking yes, fill in box G)
- h) anything of a similar description to that falling within (e), (f) or (g) (if ticking yes, fill in box H)

**Provision of late night refreshment** (if ticking yes, fill in box I)

**Supply of alcohol** (if ticking yes, fill in box J)

**In all cases complete boxes K, L and M**

A

Plays Standard days and timings (please read guidance note 8)			<u>Will the performance of a play take place indoors or outdoors or both – please tick</u> (please read guidance note 4)	Indoors	<input type="checkbox"/>
				Outdoors	<input type="checkbox"/>
				Both	<input type="checkbox"/>
Day	Start	Finish			
Mon			<u>Please give further details here</u> (please read guidance note 5)		
Tue					
Wed			<u>State any seasonal variations for performing plays</u> (please read guidance note 6)		
Thur					
Fri			<u>Non standard timings. Where you intend to use the premises for the performance of plays at different times to those listed in the column on the left, please list</u> (please read guidance note 7)		
Sat					
Sun					

B

Films Standard days and timings (please read guidance note 8)			<u>Will the exhibition of films take place indoors or outdoors or both – please tick (please read guidance note 4)</u>	Indoors	<input type="checkbox"/>
				Outdoors	<input type="checkbox"/>
				Both	<input type="checkbox"/>
Day	Start	Finish			
Mon			<u>Please give further details here (please read guidance note 5)</u>		
Tue			<u>State any seasonal variations for the exhibition of films (please read guidance note 6)</u>		
Wed			<u>Non standard timings. Where you intend to use the premises for the exhibition of films at different times to those listed in the column on the left, please list (please read guidance note 7)</u>		
Thur					
Fri					
Sat					
Sun					

C

Indoor sporting events Standard days and timings (please read guidance note 8)			<u>Please give further details</u> (please read guidance note 5)
Day	Start	Finish	
Mon			
Tue			<u>State any seasonal variations for indoor sporting events</u> (please read guidance note 6)
Wed			
Thur			<u>Non standard timings. Where you intend to use the premises for indoor sporting events at different times to those listed in the column on the left, please list</u> (please read guidance note 7)
Fri			
Sat			
Sun			

D

Boxing or wrestling entertainments Standard days and timings (please read guidance note 8)			<u>Will the boxing or wrestling entertainment take place indoors or outdoors or both – please tick</u> (please read guidance note 4)	Indoors	<input type="checkbox"/>
				Outdoors	<input type="checkbox"/>
				Both	<input type="checkbox"/>
Day	Start	Finish	<u>Please give further details here</u> (please read guidance note 5)		
Mon					
Tue			<u>State any seasonal variations for boxing or wrestling entertainment</u> (please read guidance note 6)		
Wed					
Thur			<u>Non standard timings. Where you intend to use the premises for boxing or wrestling entertainment at different times to those listed in the column on the left, please list</u> (please read guidance note 7)		
Fri					
Sat					
Sun					

E

Live music Standard days and timings (please read guidance note 8)			Will the performance of live music take place <u>indoors or outdoors or both – please tick</u> (please read guidance note 4)	Indoors	<input type="checkbox"/>
				Outdoors	<input type="checkbox"/>
				Both	<input type="checkbox"/>
Day	Start	Finish	Please give further details here (please read guidance note 5)		
Mon					
Tue			State any seasonal variations for the performance of live music (please read guidance note 6)		
Wed					
Thur			Non standard timings. Where you intend to use the premises for the <u>performance of live music at different times to those listed in the column on the left, please list</u> (please read guidance note 7)		
Fri					
Sat					
Sun					

F

Recorded music Standard days and timings (please read guidance note 8)			<u>Will the playing of recorded music take place indoors or outdoors or both – please tick (please read guidance note 4)</u>	Indoors	<input type="checkbox"/>
				Outdoors	<input type="checkbox"/>
				Both	<input type="checkbox"/>
Day	Start	Finish	<u>Please give further details here (please read guidance note 5)</u>		
Mon					
Tue			<u>State any seasonal variations for the playing of recorded music (please read guidance note 6)</u>		
Wed					
Thur			<u>Non standard timings. Where you intend to use the premises for the playing of recorded music at different times to those listed in the column on the left, please list (please read guidance note 7)</u>		
Fri					
Sat					
Sun					

G

<b>Performances of dance</b> Standard days and timings (please read guidance note 8)			<b><u>Will the performance of dance take place indoors or outdoors or both – please tick</u></b> (please read guidance note 4)	Indoors	<input type="checkbox"/>
				Outdoors	<input type="checkbox"/>
				Both	<input type="checkbox"/>
Day	Start	Finish	<b><u>Please give further details here</u></b> (please read guidance note 5)		
Mon					
Tue					
Wed			<b><u>State any seasonal variations for the performance of dance</u></b> (please read guidance note 6)		
Thur					
Fri			<b><u>Non standard timings. Where you intend to use the premises for the performance of dance at different times to those listed in the column on the left, please list</u></b> (please read guidance note 7)		
Sat					
Sun					



H

<p><b>Anything of a similar description to that falling within (e), (f) or (g)</b> Standard days and timings (please read guidance note 8)</p>			<p>Please give a description of the type of entertainment you will be providing</p>		
Day	Start	Finish	<p><b><u>Will this entertainment take place indoors or outdoors or both – please tick</u></b> (please read guidance note 4)</p>	Indoors	<input type="checkbox"/>
Mon				Outdoors	<input type="checkbox"/>
				Both	<input type="checkbox"/>
Tue			<p><b><u>Please give further details here</u></b> (please read guidance note 5)</p>		
Wed					
Thur			<p><b><u>State any seasonal variations for entertainment of a similar description to that falling within (e), (f) or (g)</u></b> (please read guidance note 6)</p>		
Fri					
Sat			<p><b><u>Non standard timings. Where you intend to use the premises for the entertainment of a similar description to that falling within (e), (f) or (g) at different times to those listed in the column on the left, please list</u></b> (please read guidance note 7)</p>		
Sun					

I

<b>Late night refreshment</b> Standard days and timings (please read guidance note 8)			<b>Will the provision of late night refreshment take place indoors or outdoors or both – please tick</b> (please read guidance note 4)	Indoors	<input type="checkbox"/>
				Outdoors	<input type="checkbox"/>
				Both	<input checked="" type="checkbox"/>
Day	Start	Finish	<b>Please give further details here</b> (please read guidance note 5)		
Mon	23.00	03.00			
Tue	23.00	03.00			
			<b>State any seasonal variations for the provision of late night refreshment</b> (please read guidance note 6)		
Wed	23.00	03.00			
Thur	23.00	03.00			
			<b>Non standard timings. Where you intend to use the premises for the provision of late night refreshment at different times, to those listed in the column on the left, please list</b> (please read guidance note 7)  As per those contained within the premises licence.		
Fri	23.00	03.00			
Sat	23.00	03.00			
Sun	23.00	03.00			

J

<b>Supply of alcohol</b> Standard days and timings (please read guidance note 8)			<b>Will the supply of alcohol be for consumption – please tick</b> (please read guidance note 9)	On the premises	<input type="checkbox"/>
				Off the premises	<input type="checkbox"/>
				Both	<input type="checkbox"/>
Day	Start	Finish	<b><u>State any seasonal variations for the supply of alcohol</u></b> (please read guidance note 6)		
Mon					
Tue					
Wed					
Thur					
Fri					
Sat					
Sun			<b><u>Non-standard timings. Where you intend to use the premises for the supply of alcohol at different times to those listed in the column on the left, please list</u></b> (please read guidance note 7)		

K

<p><b>Please highlight any adult entertainment or services, activities, other entertainment or matters ancillary to the use of the premises that may give rise to concern in respect of children</b> (please read guidance note 10).</p> <p>N/a</p>
---

L

<b>Hours premises are open to the public</b> Standard days and timings (please read guidance note 8)			<b><u>State any seasonal variations</u></b> (please read guidance note 6)  The hours listed to the left are as per those already permitted by the licence.
Day	Start	Finish	<b><u>Non standard timings. Where you intend the premises to be open to the public at different times from those listed in the column on the left, please list</u></b> (please read guidance note 7)  As per those already contained within the licence.
Mon	09.00	03.30	
Tue	09.00	03.30	
Wed	09.00	03.30	
Thur	09.00	03.30	
Fri	09.00	03.30	
Sat	09.00	03.30	
Sun	09.00	03.30	

Please identify those conditions currently imposed on the licence which you believe could be removed as a consequence of the proposed variation you are seeking.

Please tick as appropriate

- I have enclosed the premises licence
- I have enclosed the relevant part of the premises licence

If you have not ticked one of these boxes, please fill in reasons for not including the licence or part of it below

Reasons why I have not enclosed the premises licence or relevant part of premises licence.

**M** Describe any additional steps you intend to take to promote the four licensing objectives as a result of the proposed variation:

**a) General – all four licensing objectives (b, c, d and e) (please read guidance note 11)**

Please refer to those conditions already contained within the licence.

**b) The prevention of crime and disorder**

Please refer to those conditions already contained within the licence.

**c) Public safety**

Please refer to those conditions already contained within the licence.

**d) The prevention of public nuisance**

Please refer to those conditions already contained within the licence.

**e) The protection of children from harm**

Please refer to those conditions already contained within the licence.

Checklist:

Please tick to indicate agreement

- I have made or enclosed payment of the fee; or
- I have not made or enclosed payment of the fee because this application has been made in relation to the introduction of the late night levy.
- I have sent copies of this application and the plan to responsible authorities and others where applicable.
- I understand that I must now advertise my application.
- I have enclosed the premises licence or relevant part of it or explanation.
- I understand that if I do not comply with the above requirements my application will be rejected.

**IT IS AN OFFENCE, UNDER SECTION 158 OF THE LICENSING ACT 2003, TO MAKE A FALSE STATEMENT IN OR IN CONNECTION WITH THIS APPLICATION. THOSE WHO MAKE A FALSE STATEMENT MAY BE LIABLE ON SUMMARY CONVICTION TO A FINE OF ANY AMOUNT.**

**Part 5 – Signatures** (please read guidance note 12)

**Signature of applicant (the current premises licence holder) or applicant’s solicitor or other duly authorised agent** (please read guidance note 13). **If signing on behalf of the applicant, please state in what capacity.**

Signature	<i>Kuit Steinart Levy LLP</i>
Date	15 May 2019
Capacity	Solicitors

**Where the premises licence is jointly held, signature of 2nd applicant (the current premises licence holder) or 2nd applicant’s solicitor or other authorised agent** (please read guidance note 14). **If signing on behalf of the applicant, please state in what capacity.**

Signature	
Date	
Capacity	

**Contact name (where not previously given) and address for correspondence associated with this application** (please read guidance note 15)

Kuit Steinart Levy LLP  
3 St Mary’s Parsonage

Post town	Manchester	Post code	M3 2RD
Telephone number (if any)	0161 838 7888		

If you would prefer us to correspond with you by e-mail, your e-mail address (optional)  
felicitytulloch@kuits.com

### Notes for Guidance

**This application cannot be used to vary the licence so as to extend the period for which the licence has effect or to vary substantially the premises to which it relates. If you wish to make that type of change to the premises licence, you should make a new premises licence application under section 17 of the Licensing Act 2003.**

1. You do not have to pay a fee if the only purpose of the variation for which you are applying is to avoid becoming liable for the late night levy
2. Describe the premises. For example, the type of premises, its general situation and layout and any other information which could be relevant to the licensing objectives. Where your application includes off-supplies of alcohol and you intend to provide a place of consumption of these off-supplies of alcohol, you must include a description of where the place will be and its proximity to the premises.
3. In terms of specific regulated entertainments please note that:
  - Plays: no licence is required for performances between 08.00 and 23.00 on any day, provided that the audience does not exceed 500.
  - Films: no licence is required for 'not-for-profit' film exhibition held in community premises between 08.00 and 23.00 on any day provided that the audience does not exceed 500 and the organiser (a) gets consent to the screening from a person who is responsible for the premises; and (b) ensures that each such screening abides by age classification ratings.
  - Indoor sporting events: no licence is required for performances between 08.00 and 23.00 on any day, provided that the audience does not exceed 1000.
  - Boxing or Wrestling Entertainment: no licence is required for a contest, exhibition or display of Greco-Roman wrestling, or freestyle wrestling between 08.00 and 23.00 on any day, provided that the audience does not exceed 1000. Combined fighting sports – defined as a contest, exhibition or display which combines boxing or wrestling with one or more martial arts – are licensable as a boxing or wrestling entertainment rather than an indoor sporting event.
  - Live music: no licence permission is required for:
    - a performance of unamplified live music between 08.00 and 23.00 on any day, on any premises.
    - a performance of amplified live music between 08.00 and 23.00 on any day on premises authorised to sell alcohol for consumption on those premises, provided that the audience does not exceed 500.
    - a performance of amplified live music between 08.00 and 23.00 on any day, in a workplace that is not licensed to sell alcohol on those premises, provided that the audience does not exceed 500.
    - a performance of amplified live music between 08.00 and 23.00 on any day, in a church hall, village hall, community hall, or other similar community premises, that is not licensed by a premises licence to sell alcohol, provided that (a) the audience does not exceed 500, and (b) the organiser gets consent for the performance from a person who is responsible for the premises.
    - a performance of amplified live music between 08.00 and 23.00 on any day, at the non-residential premises of (i) a local authority, or (ii) a school, or (iii) a hospital, provided that (a) the audience does not exceed 500, and (b) the organiser gets consent for the performance on the relevant premises from: (i) the local authority concerned, or (ii) the school or (iii) the health care provider for the hospital.



- Recorded Music: no licence permission is required for:
    - any playing of recorded music between 08.00 and 23.00 on any day on premises authorised to sell alcohol for consumption on those premises, provided that the audience does not exceed 500.
    - any playing of recorded music between 08.00 and 23.00 on any day, in a church hall, village hall, community hall, or other similar community premises, that is not licensed by a premises licence to sell alcohol, provided that (a) the audience does not exceed 500, and (b) the organiser gets consent for the performance from a person who is responsible for the premises.
    - any playing of recorded music between 08.00 and 23.00 on any day, at the non-residential premises of (i) a local authority, or (ii) a school, or (iii) a hospital, provided that (a) the audience does not exceed 500, and (b) the organiser gets consent for the performance on the relevant premises from: (i) the local authority concerned, or (ii) the school proprietor or (iii) the health care provider for the hospital.
  - Dance: no licence is required for performances between 08.00 and 23.00 on any day, provided that the audience does not exceed 500. However, a performance which amounts to adult entertainment remains licensable.
  - Cross activity exemptions: no licence is required between 08.00 and 23.00 on any day, with no limit on audience size for:
    - any entertainment taking place on the premises of the local authority where the entertainment is provided by or on behalf of the local authority;
    - any entertainment taking place on the hospital premises of the health care provider where the entertainment is provided by or on behalf of the health care provider;
    - any entertainment taking place on the premises of the school where the entertainment is provided by or on behalf of the school proprietor; and
    - any entertainment (excluding films and a boxing or wrestling entertainment) taking place at a travelling circus, provided that (a) it takes place within a moveable structure that accommodates the audience, and (b) that the travelling circus has not been located on the same site for more than 28 consecutive days.
4. Where taking place in a building or other structure please tick as appropriate (indoors may include a tent).
  5. For example state type of activity to be authorised, if not already stated, and give relevant further details, for example (but not exclusively) whether or not music will be amplified or unamplified.
  6. For example (but not exclusively), where the activity will occur on additional days during the summer months.
  7. For example (but not exclusively), where you wish the activity to go on longer on a particular day e.g. Christmas Eve.
  8. Please give timings in 24 hour clock (e.g. 16.00) and only give details for the days of the week when you intend the premises to be used for the activity.
  9. If you wish people to be able to consume alcohol on the premises, please tick 'on the premises'. If you wish people to be able to purchase alcohol to consume away from the premises, please tick 'off the premises'. If you wish people to be able to do both, please tick 'both'.
  10. Please give information about anything intended to occur at the premises or ancillary to the use of the premises which may give rise to concern in respect of children regardless of whether you intend children to have access to the premises, for example (but not exclusively) nudity or semi-nudity, films for restricted age groups or the presence of gaming machines.
  11. Please list here steps you will take to promote all four licensing objectives together.

12. The application form must be signed.
13. An applicant's agent (for example solicitor) may sign the form on their behalf provided that they have actual authority to do so.
14. Where there is more than one applicant, each of the applicants or their respective agents must sign the application form.
15. This is the address which we shall use to correspond with you about this application.



**FIRST FLOOR PLAN**  
 FIRST FLOOR MAIN PAINTS AREA  
 03/24/2012  
 DRAWN BY: J. J. KASSEL

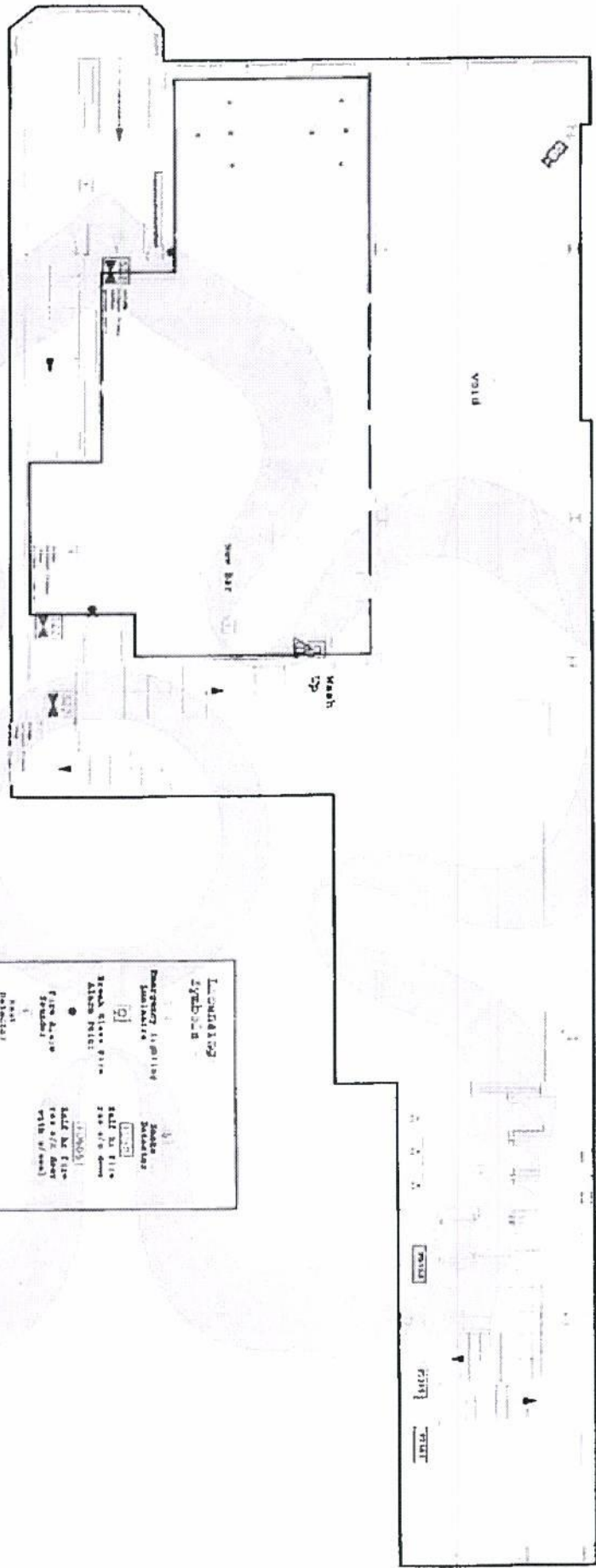

**LOADING SYSTEMS**  
 Emergency Lighting  
 Smoke Detector  
 Fire Alarm  
 Fire Alarm Control Panel  
 Fire Alarm Pull Station  
 Fire Alarm Sounder  
 Fire Alarm Speaker  
 Fire Alarm Strobe  
 Fire Alarm Bell  
 Fire Alarm Horn  
 Fire Alarm Chime  
 Fire Alarm Siren  
 Fire Alarm Whistle  
 Fire Alarm Gong  
 Fire Alarm Buzzer  
 Fire Alarm Trolley  
 Fire Alarm Bell  
 Fire Alarm Horn  
 Fire Alarm Chime  
 Fire Alarm Siren  
 Fire Alarm Whistle  
 Fire Alarm Gong  
 Fire Alarm Buzzer

**NOTES**  
 1. See notes on sheet 03/24/2012  
 2. See notes on sheet 03/24/2012  
 3. See notes on sheet 03/24/2012

**EXTENSIONS**  
 Fire Alarm  
 Fire Alarm Control Panel  
 Fire Alarm Pull Station  
 Fire Alarm Sounder  
 Fire Alarm Speaker  
 Fire Alarm Strobe  
 Fire Alarm Bell  
 Fire Alarm Horn  
 Fire Alarm Chime  
 Fire Alarm Siren  
 Fire Alarm Whistle  
 Fire Alarm Gong  
 Fire Alarm Buzzer

markasondesign  
 INVENTIVE DESIGN  
 10000  
 10000  
 10000

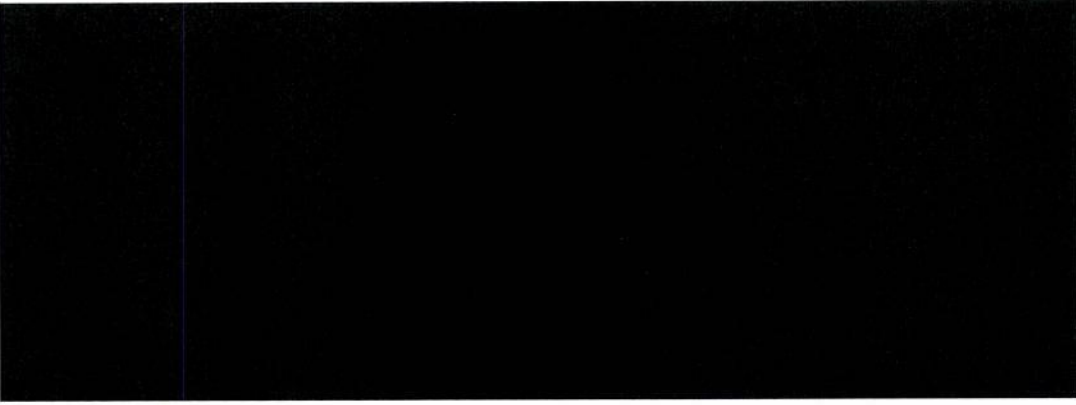

---

**From:** V [redacted]  
**Sent:** 05 June 2019 14:57  
**To:** Licensing  
**Cc:** [redacted]  
**Subject:** Revolution Bars Limited, New Walk

I understand that Revolution Bars Limited has applied to vary their Premises Licence and I wish to OBJECT.

As a Resident of New Walk I wish to object to the extension/changes proposed on the grounds that they are likely to cause increased **Public Nuisance**(noise control) and **Crime & Disorder** (cycling on New Walk)

The proposed delivery service between 11pm and 3 am, on a daily basis, is particularly irritating - a delivery service indicates that it's door to door but the only vehicle that should be used on New Walk is "Shanks's Pony" \*(see below) not cycles and definitely not motorised bikes which are already on the increase - I can't see anyone parking on Wellington Street/King Street and collecting deliveries or walking their bikes on New Walk!

The increase in noise in this residential area is already often at a barely tolerable level and the proposed delivery service is certain to exacerbate the nuisance this causes to residents.

Are lives are being blighted by drinkers and delivery companies (Deliveroo, UberEats, etc) using New Walk as a quick conduit for deliveries and Revolution and other similar establishments operate without consideration for the location or its residents.



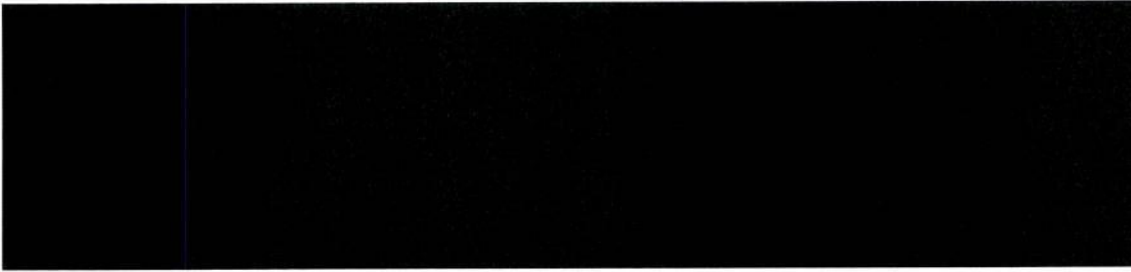

---

**From:** [Redacted]  
**Sent:** 05 June 2019 15:06  
**To:** Licensing  
**Cc:** [Redacted]  
**Subject:** Revolution Bars Limited, New Walk

The Friends of New Walk have asked me to write expressing their wish to Object to the proposed Delivery extension (11.00 pm to 3.00 am daily) relating to the above revised Premises Licence.

It is considered that this will cause a **Public Nuisance (Noise Control)** and is totally inappropriate to the location of the Revolution and detrimental to the lives of Residents of New Walk, whose sleep would undoubtedly be affected by the noise nuisance.

They would also like to add that New Walk is a **traffic free promenade**.

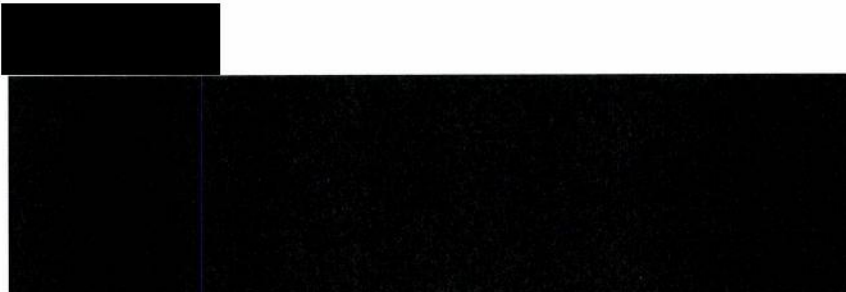





## CONDITIONS

<b>CONDITIONS CONSISTENT WITH OPERATING SCHEDULE</b>
Licensable activities may continue between the end of hours permitted by the licence on New Year's Eve and the start of the hours permitted by the licence on New Year's Day
The premises are structurally adapted and bona fide/intended to be used for the purpose of providing for persons resorting to the premises music and dancing and substantial refreshment to which the sale of intoxicating liquor is ancillary
On the morning when summer time begins, alcohol may be sold and regulated entertainment may be provided until 3am
Consumption of liquor and other refreshments in the outside area on the plan shall be restricted to those persons seated at tables serviced by waiter/waitresses to a terminal hour of 11.00pm. This facility to be closed under the direction of a police officer either during or in anticipation of public disorder
CCTV to be installed, operated and maintained both internally and externally under the direction of the Crime Prevention Officer
Windows and doors (apart from access and egress) to be kept closed during the provision of any regulated entertainment
There shall be no external playing of amplified music and voice



By virtue of paragraph(s) 1, 2, 3 of Part 1 of Schedule 12A  
of the Local Government Act 1972.

Document is Restricted

